

## GOLDENDALE SHOP - A2335A6FT-0

Total Area: **0 Sq. Ft.**  
Garage Area: **2336 Sq. Ft.**  
Garage Size: **5+**  
Stories: **1**  
Bedrooms :  
Full Baths :  
Half Baths :  
Width : **56`-0"**  
Depth : **48`-0"**  
Height : **27`-0"**  
Foundation : **Slab**



GOLDENDALE SHOP - A2335A6FT-0

MAIN FLOOR

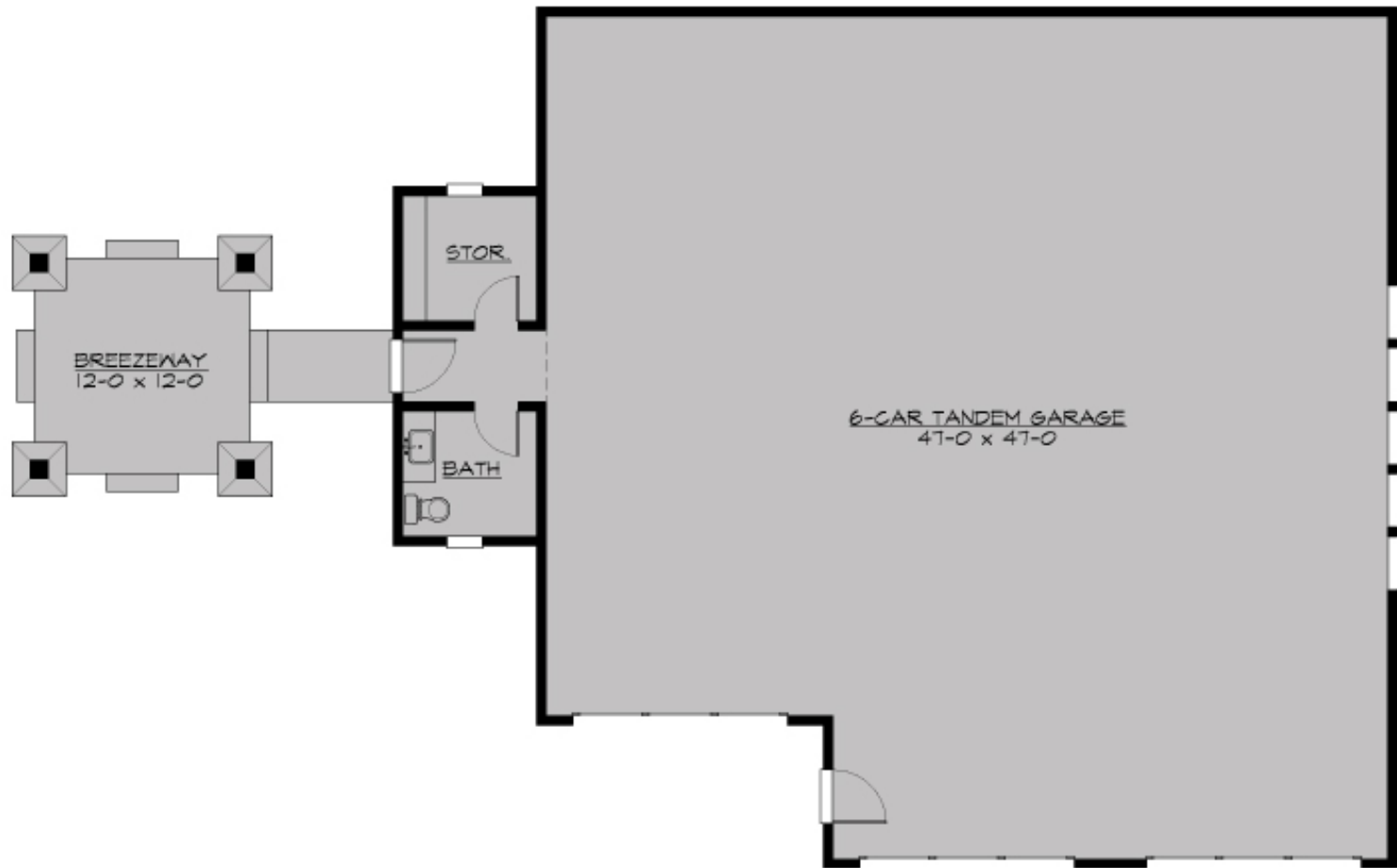

# GOLDENDALE SHOP - A2335A6FT-0

## PLAN DETAILS

### Area Summary

Garage Floor: 2336 Sq. Ft.

### Wall Heights

Main: 16'-0"

### General Information

Stories: 1  
Width: 56'-0"  
Depth: 48'-0"  
Height: 27'-0"

### Foundation Type

Slab On Grade

### Roof Framing

Trusses

### Architectural Style

Country  
Craftsman  
Farmhouse

### Floor Load

Live (lbs): 40 PSF  
Dead (lbs): 10 PSF

### Number of Rooms

### Roof Load

Live (lbs): 25 PSF  
Dead (lbs): 15 PSF  
Wind: 85 MPH

### Garage

Garage Size: 5+  
Garage Door Location: Front  
Garage Type: Tandem

### Design Features

- Great Room
- Country House Plans
- Craftsman House Plans
- Farmhouse Home Plans
- Affordable Home Designs
- Wide Lot House Plans

### Roof Pitches

Primary: 8:12  
Secondary: 4:12