

BRYCEN - R1930A3F-0

Total Area: **1930 Sq. Ft.**
Garage Area: **780 Sq. Ft.**
Garage Size: **3**
Stories: **1**
Bedrooms : **3**
Full Baths : **2**
Half Baths :
Width : **66`-0"**
Depth : **60`-0"**
Height : **21`-6"**
Foundation : **Crawl Space**



BRYCEN - R1930A3F-0

MAIN FLOOR

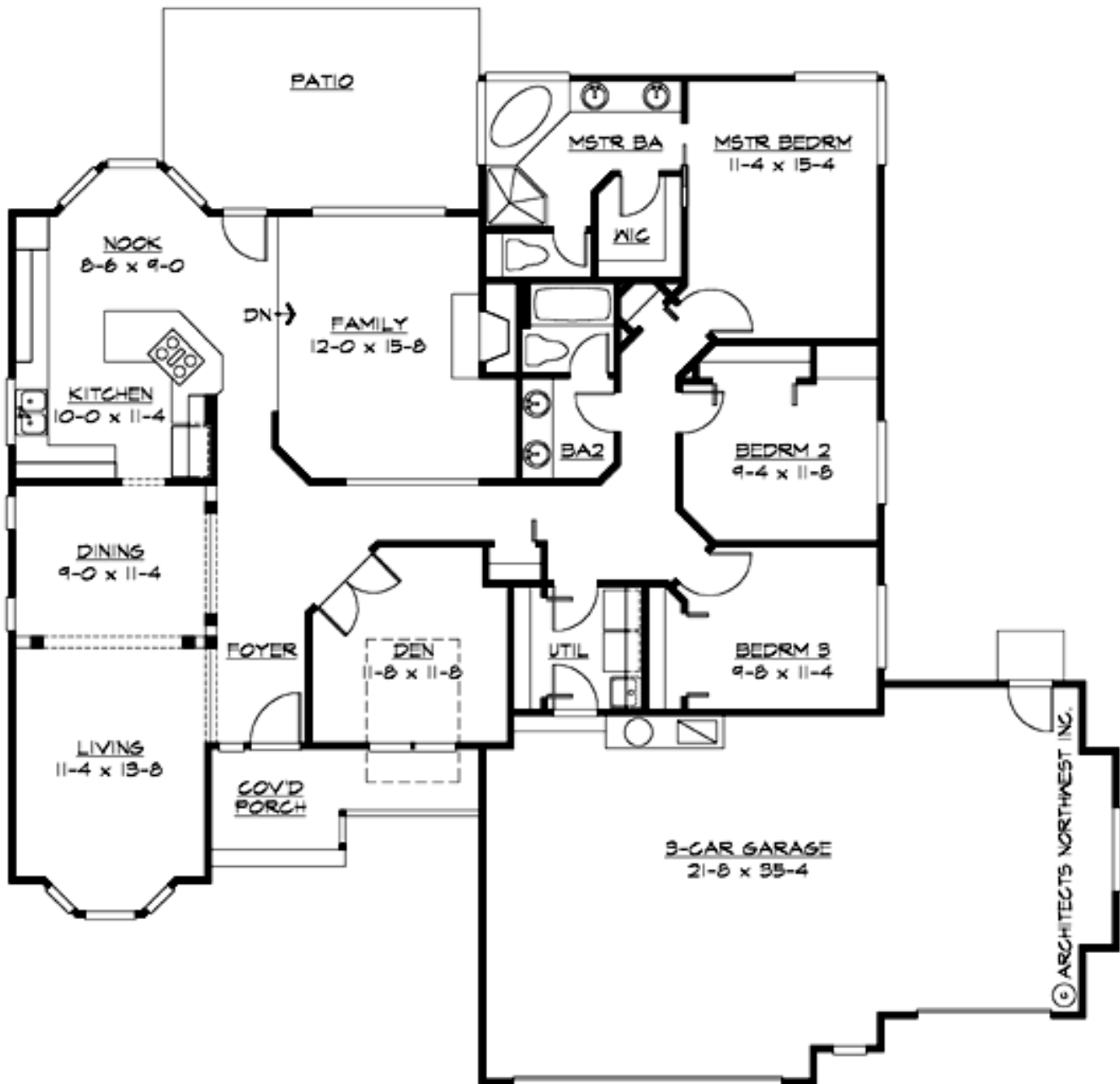

BRYCEN - R1930A3F-0

PLAN DETAILS

Area Summary

Total Area: **1930 Sq. Ft.**
Main Floor: **1930 Sq. Ft.**
Garage Floor: **780 Sq. Ft.**

General Information

Stories: **1**
Width: **66`-0"**
Depth: **60`-0"**
Height: **21`-6"**

Architectural Style

Craftsman
Farmhouse
Ranch

Number of Rooms

Bedrooms: **3**
Full Baths: **2**

Garage

Garage Size: **3**
Garage Door Location: **Front**

Roof Pitches

Primary: **8:12**

Wall Heights

Main: **9-0"**

Foundation Type

Crawl Space

Roof Framing

Trusses

Floor Load

Live (lbs): **40 PSF**
Dead (lbs): **10 PSF**

Roof Load

Live (lbs): **25 PSF**
Dead (lbs): **15 PSF**
Wind: **85 MPH**

Design Features

- Den/Office
- Front Porch
- Great Room
- Laundry Room @ Main Floor
- Master Bedroom @ Main Floor Rear
- Craftsman House Plans
- Farmhouse Home Plans
- Ranch House Plans
- Affordable Home Designs
- Small House Plans